

# Panoramic Bullet Network Camera

## Quick Start Guide

- Please read this instruction carefully before using the product and keep it for further reference.
- All the examples and pictures used here are for reference only.
- The contents of this manual are subject to change without notice.

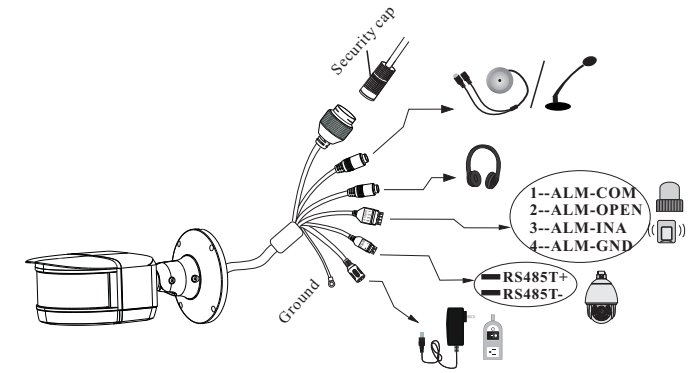
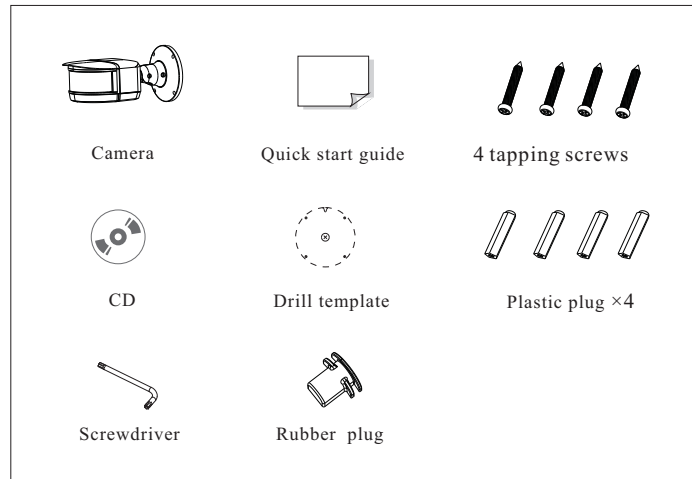

### ● Connecting Alarm Input/Output

#### Alarm Input

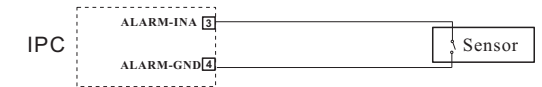

#### Alarm Output

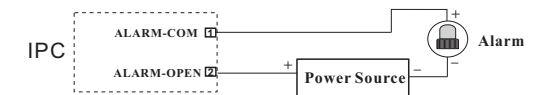

### ● Connecting Network Cable

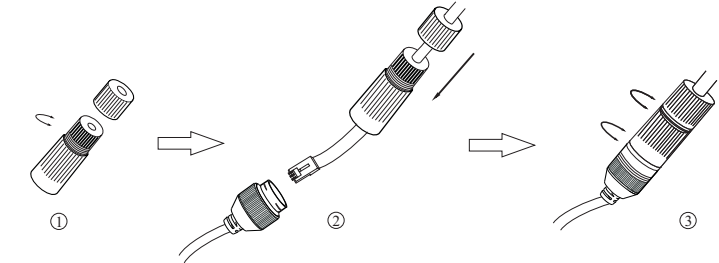

- ① Loosen the nut from the main element.
- ② Run the network cable (without RJ 45 connector) through the both elements. Then crimp the cable with RJ 45 connector.
- ③ Connect the cable to the Ethernet connector. Then tighten the nut and the main cover.

## 1 Warning and Caution

- If the product does not work properly, please contact your dealer or the nearest service center. Never attempt to disassemble the camera yourself. (We shall not be responsible for any problems caused by unauthorized repair or maintenance.)
- Do not allow water or liquid intrusion into the camera.
- In the use of the product, you must be strict compliance with the electrical safety regulations of the nation and region. When the product is mounted on wall or ceiling, the device shall be firmly fixed.
- Do not use camera beyond specified voltage range.
- Do not drop the camera or subject it to physical shock.
- The grounding hole of the product is recommended to be grounded to further enhance the reliability of the camera.
- Avoid touching the camera lens.
- If cleaning is necessary, please use clean cloth to wipe it gently.
- Do not aim the camera at the sun or extra bright place.
- Do not place the camera in extremely hot, cold, dusty or damp locations, and do not expose it to high electromagnetic radiation.
- To avoid heat accumulation, good ventilation is required for operating environment.

## 2 Package

## 3 Overview

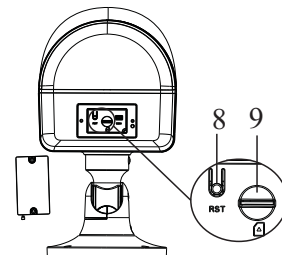
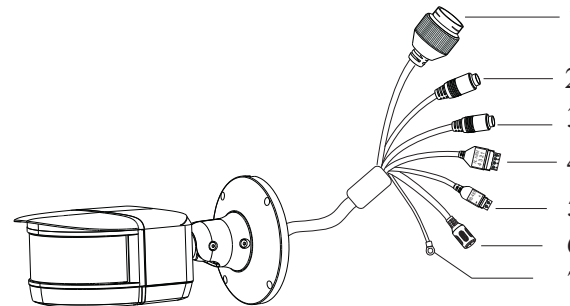

- 1 Ethernet Connector \*
- 2 Audio Input (MIC)
- 3 Audio Output (HP)
- 4 Alarm Input/Output
- 5 RS485
- 6 Power Connector \*
- 7 Ground
- 8 Reset
- 9 Micro SD Card Slot

\* 1 It is recommended to install the security cap for outdoor installation.

\* 2 This camera can be powered by DC 12V/PoE power supply. If the PoE switch is used to power the camera, DC12V power supply is not required.

## 4 Installation

Please make sure that the wall or ceiling is strong enough to withstand 3 times the weight of the camera.

- ① Open the cover of the camera and then insert a micro SD card. Then install back this cover and fix it firmly with the screws (please keep it flat when installing).

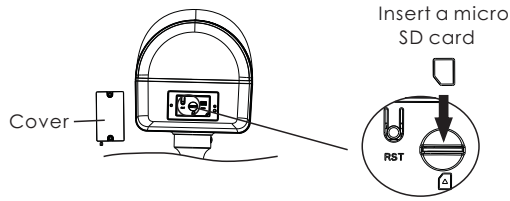

② Drill the screw holes and the cable hole (if you want to route through the ceiling) on the wall or ceiling according to the drill template.

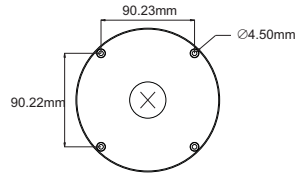

③ Route the cables and connect the relevant cables. Then fasten the mounting base to the wall with the screws provided.

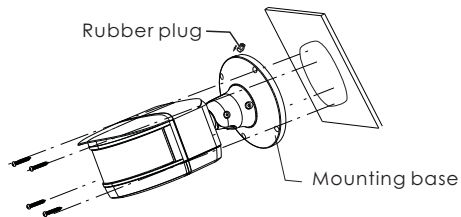

④ Bracket adjustment. Before adjustment, preview the image of the camera on a monitor and then loosen the fixed screws to adjust the view angle of the camera. After that, tighten the fixed screws.

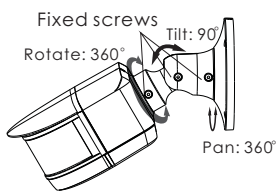

## ● Camera Mounting with a Junction Box

① Mount the junction box to the wall or ceiling with screws.

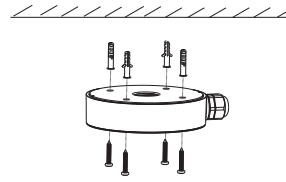

② Route the cables and connect the relevant cables (Take cable going through mounting surface for example).

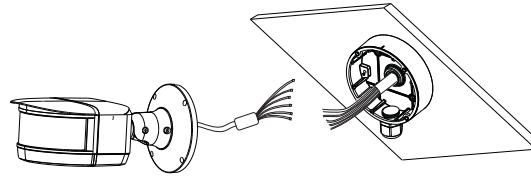

③ Fix the camera onto the junction box with screws.

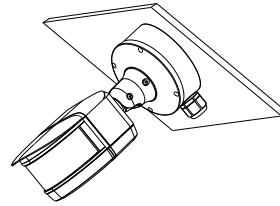

### Tips

#### Daily Maintenance

Lens cover is an optical element. Please don't touch or wipe the cover surface directly during installation and use. Please follow these cleaning tips to clean it.

- \* If there is dust on the lens cover, please use a dry soft brush to gently brush it.
- \* If there is water or grease on the lens cover, please gently wipe off the water or grease with a soft cloth. Then use oil-free cotton cloth with a little neutral detergent to wipe it several times until it is clean. Finally, change the cloth to dry it.
- \* If there are fingerprints on the lens cover, please use oil-free cotton cloth or paper soaked with a little neutral detergent to wipe it several times and then dry it with a soft cloth.

## 5 Network Connection

Here we take accessing IP camera via LAN for example.

### ● Access Through IP-Tool

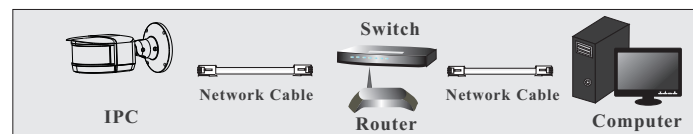

① Make sure that the camera and the PC are well connected to the LAN.

② Find the IP-Tool from the CD and then install it in the computer. After that, run the IP-Tool as shown below.

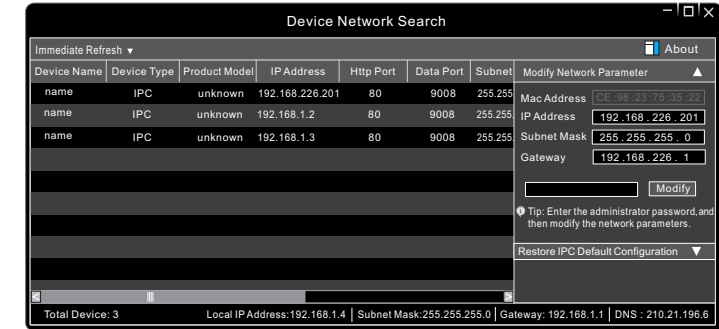

③ Modify the IP address. The default IP address of this camera is 192.168.226.201. Click the information of the camera listed in the above table to show the network information on the right hand. Modify the IP address and gateway of the camera and make sure its network address is in the same local network segment as that of the computer. Please modify the IP address of your device according to the practical situation.

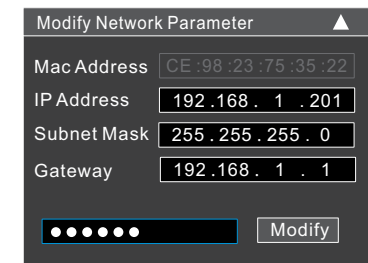

For example, the IP address of your computer is 192.168.1.4. So the IP address of the camera shall be changed to 192.168.1.X. After modification, please enter the password of the administrator and click “Modify” button to modify the setting.

⚠ The default password of the administrator is “123456”.

④ Double-click the IP address to open up the web browser or manually enter the modified IP address in the address bar of your browser. Then follow directions to download and install the plugin if it is the first time for you to log in.

⑤ Enter the user name and password in the login interface.

⚠ The default username is *admin*; the default password is 123456.